



2022 CRUISE GUIDE AMERICAN EMPRESS®



 AMERICAN QUEEN®
STEAMBOAT COMPANY



Uniquely American River Cruises



AMERICAN EMPRESS VOYAGE CALENDAR

ALL VOYAGES ARE 9 DAYS UNLESS NOTED OTHERWISE.

DATE	ITINERARY	VOYAGE NAME	D	E	C	B	A	LS	SO
Mar 13	Portland (Vancouver, WA) to Spokane (Clarkston, WA) <i>Astoria, Portland, Stevenson, The Dalles, Richland (Tri-Cities), Clarkston</i>	Pacific Northwest Passage	\$2,899	\$2,999	\$3,199	\$4,199	\$4,999	\$7,099	\$3,699
Mar 20	Spokane (Clarkston, WA) to Portland (Vancouver, WA) <i>Clarkston, Richland (Tri-Cities), The Dalles, Stevenson, Astoria</i>	Pacific Northwest Passage	\$2,899	\$2,999	\$3,199	\$4,199	\$4,999	\$7,099	\$3,699
Mar 27	Portland (Vancouver, WA) to Spokane (Clarkston, WA) <i>Astoria, Portland, Stevenson, The Dalles, Richland (Tri-Cities), Clarkston</i>	Pacific Northwest Passage	\$2,899	\$2,999	\$3,199	\$4,199	\$4,999	\$7,099	\$3,699
Apr 3	Spokane (Clarkston, WA) to Portland (Vancouver, WA) <i>Clarkston, Richland (Tri-Cities), The Dalles, Stevenson, Astoria</i>	Pacific Northwest Passage	\$2,899	\$2,999	\$3,199	\$4,199	\$4,999	\$7,099	\$3,699
Apr 10	Portland (Vancouver, WA) to Spokane (Clarkston, WA) <i>Astoria, Portland, Stevenson, The Dalles, Richland (Tri-Cities), Clarkston</i>	Pacific Northwest Passage	\$2,899	\$2,999	\$3,199	\$4,199	\$4,999	\$7,099	\$3,699
Apr 17	Spokane (Clarkston, WA) to Portland (Vancouver, WA) <i>Clarkston, Richland (Tri-Cities), The Dalles, Stevenson, Astoria</i>	Pacific Northwest Passage	\$2,899	\$2,999	\$3,199	\$4,199	\$4,999	\$7,099	\$3,699
Apr 24	Portland (Vancouver, WA) to Spokane (Clarkston, WA) <i>Astoria, Portland, Stevenson, The Dalles, Richland (Tri-Cities), Clarkston</i>	Pacific Northwest Passage	\$2,899	\$2,999	\$3,199	\$4,199	\$4,999	\$7,099	\$3,699
May 1	Spokane (Clarkston, WA) to Portland (Vancouver, WA) <i>Clarkston, Richland (Tri-Cities), The Dalles, Stevenson, Astoria</i>	Pacific Northwest Passage	\$3,399	\$3,399	\$3,699	\$4,799	\$5,699	\$8,099	\$4,199
May 8	Portland (Vancouver, WA) to Spokane (Clarkston, WA) <i>Astoria, Portland, Stevenson, The Dalles, Richland (Tri-Cities), Clarkston</i>	Pacific Northwest Passage	\$3,399	\$3,399	\$3,699	\$4,799	\$5,699	\$8,099	\$4,199
May 15	Spokane (Clarkston, WA) to Portland (Vancouver, WA) <i>Clarkston, Richland (Tri-Cities), The Dalles, Stevenson, Astoria</i>	Pacific Northwest Passage	\$3,399	\$3,399	\$3,699	\$4,799	\$5,699	\$8,099	\$4,199
May 22	Portland (Vancouver, WA) to Spokane (Clarkston, WA) <i>Astoria, Portland, Stevenson, The Dalles, Richland (Tri-Cities), Clarkston</i>	Pacific Northwest Passage	\$3,399	\$3,399	\$3,699	\$4,799	\$5,699	\$8,099	\$4,199
May 29	Spokane (Clarkston, WA) to Portland (Vancouver, WA) <i>Clarkston, Richland (Tri-Cities), The Dalles, Stevenson, Astoria</i>	Pacific Northwest Passage	\$3,799	\$3,899	\$4,199	\$5,399	\$6,499	\$9,199	\$4,699
Jun 5	Portland (Vancouver, WA) to Spokane (Clarkston, WA) <i>Astoria, Portland, Stevenson, The Dalles, Richland (Tri-Cities), Clarkston</i>	Pacific Northwest Passage	\$3,799	\$3,899	\$4,199	\$5,399	\$6,499	\$9,199	\$4,699
Jun 12	Spokane (Clarkston, WA) to Portland (Vancouver, WA) <i>Clarkston, Richland (Tri-Cities), The Dalles, Stevenson, Astoria</i>	Pacific Northwest Passage	\$3,799	\$3,899	\$4,199	\$5,399	\$6,499	\$9,199	\$4,699
Jun 19	Portland (Vancouver, WA) to Spokane (Clarkston, WA) <i>Astoria, Portland, Stevenson, The Dalles, Richland (Tri-Cities), Clarkston</i>	Pacific Northwest Passage	\$3,799	\$3,899	\$4,199	\$5,399	\$6,499	\$9,199	\$4,699
Jun 26	Spokane (Clarkston, WA) to Portland (Vancouver, WA) <i>Clarkston, Richland (Tri-Cities), The Dalles, Stevenson, Astoria</i>	Pacific Northwest Passage	\$4,199	\$4,299	\$4,599	\$5,999	\$7,199	\$10,199	\$6,199
Jul 3	Portland (Vancouver, WA) to Spokane (Clarkston, WA) <i>Astoria, Portland, Stevenson, The Dalles, Richland (Tri-Cities), Clarkston</i>	Pacific Northwest Passage	\$4,199	\$4,299	\$4,599	\$5,999	\$7,199	\$10,199	\$6,199
Jul 10	Spokane (Clarkston, WA) to Portland (Vancouver, WA) <i>Clarkston, Richland (Tri-Cities), The Dalles, Stevenson, Astoria</i>	Pacific Northwest Passage	\$4,199	\$4,299	\$4,599	\$5,999	\$7,199	\$10,199	\$6,199
Jul 17	Portland (Vancouver, WA) to Spokane (Clarkston, WA) <i>Astoria, Portland, Stevenson, The Dalles, Richland (Tri-Cities), Clarkston</i>	Pacific Northwest Passage	\$4,199	\$4,299	\$4,599	\$5,999	\$7,199	\$10,199	\$6,199
Jul 24	Spokane (Clarkston, WA) to Portland (Vancouver, WA) <i>Clarkston, Richland (Tri-Cities), The Dalles, Stevenson, Astoria</i>	Pacific Northwest Passage	\$4,199	\$4,299	\$4,599	\$5,999	\$7,199	\$10,199	\$6,199

DATE	ITINERARY	VOYAGE NAME	D	E	C	B	A	LS	SO
Jul 31	Portland (Vancouver, WA) to Spokane (Clarkston, WA) <i>Astoria, Portland, Stevenson, The Dalles, Richland (Tri-Cities), Clarkston</i>	Pacific Northwest Passage	\$4,199	\$4,299	\$4,599	\$5,999	\$7,199	\$10,199	\$6,199
Aug 7	Spokane (Clarkston, WA) to Portland (Vancouver, WA) <i>Clarkston, Richland (Tri-Cities), The Dalles, Stevenson, Astoria</i>	Pacific Northwest Passage	\$4,199	\$4,299	\$4,599	\$5,999	\$7,199	\$10,199	\$6,199
Aug 14	Portland (Vancouver, WA) to Spokane (Clarkston, WA) <i>Astoria, Portland, Stevenson, The Dalles, Richland (Tri-Cities), Clarkston</i>	Pacific Northwest Passage	\$4,199	\$4,299	\$4,599	\$5,999	\$7,199	\$10,199	\$6,199
Aug 21	Spokane (Clarkston, WA) to Portland (Vancouver, WA) <i>Clarkston, Richland (Tri-Cities), The Dalles, Stevenson, Astoria</i>	Pacific Northwest Passage	\$4,199	\$4,299	\$4,599	\$5,999	\$7,199	\$10,199	\$6,199
Aug 28	Portland (Vancouver, WA) to Spokane (Clarkston, WA) <i>Astoria, Portland, Stevenson, The Dalles, Richland (Tri-Cities), Clarkston</i>	Pacific Northwest Passage	\$4,199	\$4,299	\$4,599	\$5,999	\$7,199	\$10,199	\$6,199
Sep 4	Spokane (Clarkston, WA) to Portland (Vancouver, WA) <i>Clarkston, Richland (Tri-Cities), The Dalles, Stevenson, Astoria</i>	Pacific Northwest Passage	\$4,199	\$4,299	\$4,599	\$5,999	\$7,199	\$10,199	\$6,199
Sep 11	Portland (Vancouver, WA) to Spokane (Clarkston, WA) <i>Astoria, Portland, Stevenson, The Dalles, Richland (Tri-Cities), Clarkston</i>	Pacific Northwest Passage	\$4,199	\$4,299	\$4,599	\$5,999	\$7,199	\$10,199	\$6,199
Sep 18	Spokane (Clarkston, WA) to Portland (Vancouver, WA) <i>Clarkston, Richland (Tri-Cities), The Dalles, Stevenson, Astoria</i>	Pacific Northwest Passage	\$4,199	\$4,299	\$4,599	\$5,999	\$7,199	\$10,199	\$6,199
Sep 25	Portland (Vancouver, WA) to Spokane (Clarkston, WA) <i>Astoria, Portland, Stevenson, The Dalles, Richland (Tri-Cities), Clarkston</i>	Pacific Northwest Passage	\$4,199	\$4,299	\$4,599	\$5,999	\$7,199	\$10,199	\$6,199
Oct 2	Spokane (Clarkston, WA) to Portland (Vancouver, WA) <i>Clarkston, Richland (Tri-Cities), The Dalles, Stevenson, Astoria</i>	Pacific Northwest Passage	\$4,199	\$4,299	\$4,599	\$5,999	\$7,199	\$10,199	\$5,299
Oct 9	Portland (Vancouver, WA) to Spokane (Clarkston, WA) <i>Astoria, Portland, Stevenson, The Dalles, Richland (Tri-Cities), Clarkston</i>	Pacific Northwest Passage	\$4,199	\$4,299	\$4,599	\$5,999	\$7,199	\$10,199	\$5,299
Oct 16	Spokane (Clarkston, WA) to Portland (Vancouver, WA) <i>Clarkston, Richland (Tri-Cities), The Dalles, Stevenson, Astoria</i>	Pacific Northwest Passage	\$4,199	\$4,299	\$4,599	\$5,999	\$7,199	\$10,199	\$5,299
Oct 23	Portland (Vancouver, WA) to Spokane (Clarkston, WA) <i>Astoria, Portland, Stevenson, The Dalles, Richland (Tri-Cities), Clarkston</i>	Pacific Northwest Passage	\$3,799	\$3,899	\$4,199	\$5,399	\$6,499	\$9,199	\$4,699
Oct 30	Spokane (Clarkston, WA) to Portland (Vancouver, WA) <i>Clarkston, Richland (Tri-Cities), The Dalles, Stevenson, Astoria</i>	 Grapes and Gorges	\$3,799	\$3,899	\$4,199	\$5,399	\$6,499	\$9,199	\$4,699
Nov 6	Portland (Vancouver, WA) to Spokane (Clarkston, WA) <i>Astoria, Portland, Stevenson, The Dalles, Richland (Tri-Cities), Clarkston</i>	 Grapes and Gorges	\$3,799	\$3,899	\$4,199	\$5,399	\$6,499	\$9,199	\$4,699
Nov 13	Spokane (Clarkston, WA) to Portland (Vancouver, WA) <i>Clarkston, Richland (Tri-Cities), The Dalles, Stevenson, Astoria</i>	 Grapes and Gorges	\$3,799	\$3,899	\$4,199	\$5,399	\$6,499	\$9,199	\$4,699
Nov 20	Roundtrip Portland (Vancouver, WA) (7 days) <i>Stevenson, Astoria, The Dalles</i>	Pacific Northwest Sampler	\$1,599	\$1,599	\$1,699	\$2,199	\$2,599	\$3,699	\$1,899
Nov 25	Roundtrip Portland (Vancouver, WA) (7 days) <i>Stevenson, Astoria, Portland, The Dalles</i>	Pacific Northwest Sampler	\$1,599	\$1,599	\$1,699	\$2,199	\$2,599	\$3,699	\$1,899
Nov 30	Roundtrip Portland (Vancouver, WA) (7 days) <i>Stevenson, The Dalles, Portland, Astoria</i>	Pacific Northwest Sampler	\$1,599	\$1,599	\$1,699	\$2,199	\$2,599	\$3,699	\$1,899
Dec 5	Roundtrip Portland (Vancouver, WA) (7 days) <i>Stevenson, The Dalles, Portland, Astoria</i>	Pacific Northwest Sampler	\$1,599	\$1,599	\$1,699	\$2,199	\$2,599	\$3,699	\$1,899



Denotes a special edition voyage

Fares quoted are in U.S. dollars, per person, double occupancy, with the exception of single-occupancy category SO. Fares do not include taxes, port charges, insurance, gratuities, airfare or land transportation. All itineraries, hotels, pricing, dates and voyage names are subject to change, and we are not responsible for errors or omissions therein.

DECK PLANS

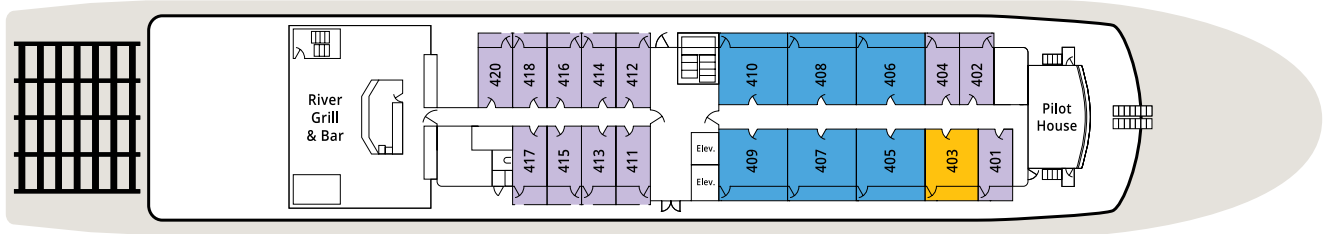

DECK 4 – VISTA VIEW DECK

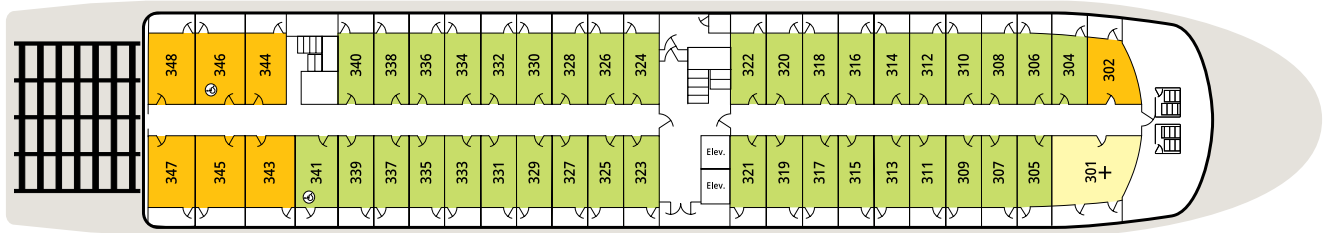

DECK 3 – DISCOVERY DECK

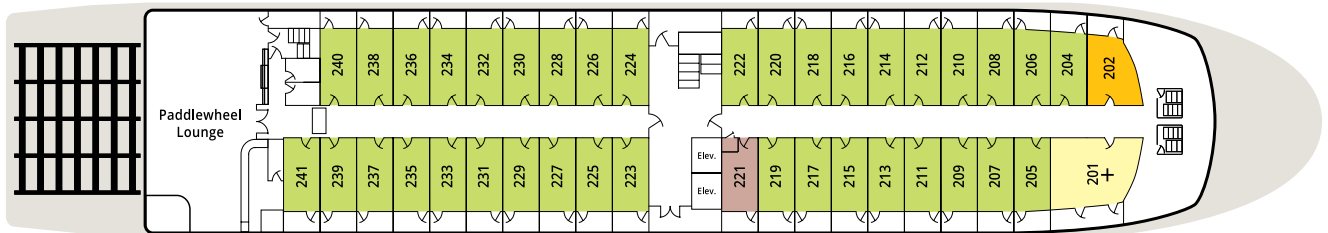

DECK 2 – FRONTIER DECK

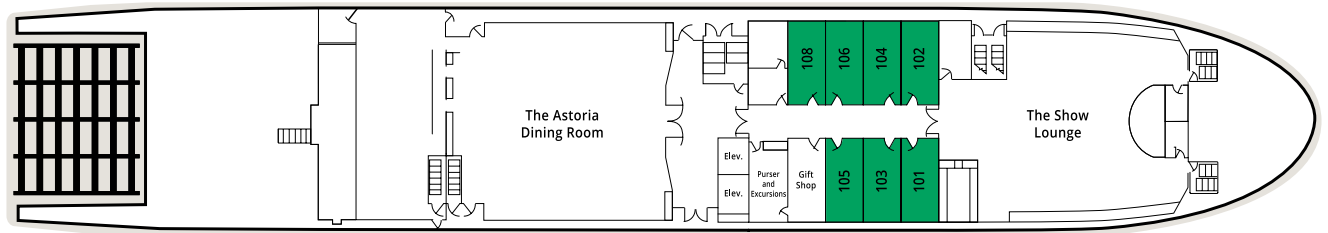

DECK 1 – EXPLORER DECK

+ Triple Occupancy

Accessible Staterooms
Staterooms 341 and 346
feature a roll-in shower.

SPECIFICATIONS

YEAR BUILT/REFURBISHED	2003/2014
LENGTH	360 FEET
SUITES AND STATEROOMS	112
PASSENGERS/CREW	221/88

SUITE AND STATEROOM CATEGORIES

LS (Yellow)	Luxury Suites with Veranda	D (Green)	Outside Staterooms with Window
A (Blue)	Suites with Veranda	E (Purple)	Veranda Staterooms
B (Orange)	Superior Veranda Staterooms	SO (Brown)	Single Outside Stateroom with Veranda
C (Light Green)	Deluxe Veranda Staterooms		

SUITES AND STATEROOMS

LS LUXURY SUITES WITH VERANDA

Feel as if you own the *American Empress* in this expansive suite. You are treated to sweeping river views through large windows facing forward and starboard. Step out onto your private veranda, and scan the riverbanks for wildlife. Converse in your spacious sitting room complete with a large flat-screen TV, premium sound, a cocktail table and a wet bar. As a guest of our Luxury Suite, you will be treated to exclusive suite-level *Commodore Services* and amenities, as well as River Butler service.

- 410 sq. ft.
- Queen bed or two single beds
- Full bathroom with shower
- Sitting area with sofa
- Private veranda
- Interior access
- Discovery and Frontier Decks
- *Commodore Services*, including a River Butler

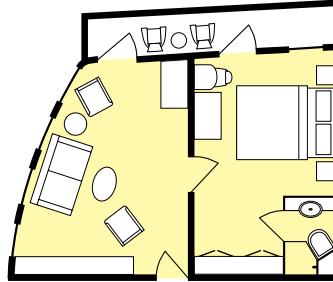

A SUITES WITH VERANDA

Enjoy a large suite with a comfortable sitting area and premium sound system. Your semi-private veranda provides splendid river views from four stories above the river, and direct access to the wraparound Vista View Deck, perfect for sharing a view and socializing with fellow guests.

- 310 sq. ft.
- Queen bed or two single beds
- Full bathroom with shower
- Sitting area with sofa
- Semi-private veranda
- Interior and exterior access
- Vista View Deck

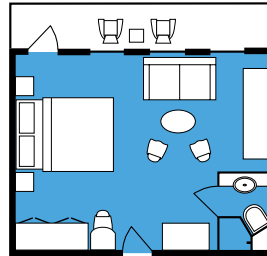

B SUPERIOR VERANDA STATEROOMS

Enjoy your spacious stateroom, with a cozy sitting area or a panoramic view through large forward-facing windows. Your private veranda provides a quiet place to watch the ever-changing scenery.

- 210-250 sq. ft.
- Queen bed or two single beds
- Full bathroom with shower
- Sitting area
- Private veranda
- Interior access
- Vista View, Discovery and Frontier Decks
- Stateroom 403 features a semi-private veranda.
- Accessible stateroom 346 is 240 sq. ft., and features a roll-in shower.

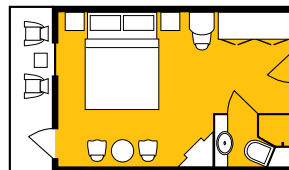

Guests holding reservations for **Luxury Suite** accommodations will receive exclusive benefits and services, including a bottle of wine from the region and seasonal fruit upon arrival, preferred dining arrangements, reserved seating in *The Show Lounge* theater and the additional services of a friendly River Butler.

C DELUXE VERANDA STATEROOMS

These staterooms are a popular choice for many couples. Share a toast on your private veranda as you glide through the fresh air of the Pacific Northwest.

- 180 sq. ft.
- Queen bed or two single beds
- Full bathroom with shower
- Private veranda
- Interior access
- Discovery and Frontier Decks
- Accessible stateroom 341 is 200 sq. ft., and features a roll-in shower.

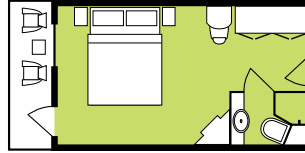

D OUTSIDE STATEROOMS WITH WINDOW

These large staterooms provide a cozy atmosphere and spectacular river views through a generously sized window.

- 180 sq. ft.
- Queen bed or two single beds
- Full bathroom with shower
- Interior access
- Explorer Deck

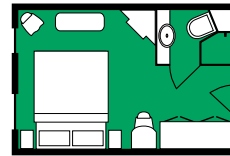

E VERANDA STATEROOMS

Enjoy a great value with our efficient yet spacious veranda staterooms. Your semi-private veranda provides a quiet place to watch the ever-changing scenery.

- 150 sq. ft.
- Queen bed or two single beds
- Full bathroom with shower
- Semi-private veranda
- Interior and exterior access
- Vista View Deck

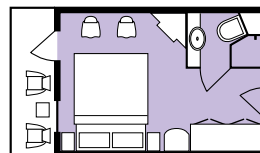

SO SINGLE OUTSIDE STATEROOM WITH VERANDA

The single outside stateroom is slightly scaled down for the single traveler, but allows you to take full advantage of the splendid features of our Deluxe Veranda Staterooms.

- 160 sq. ft.
- Single bed
- Full bathroom with shower
- Private veranda
- Interior access
- Frontier Deck

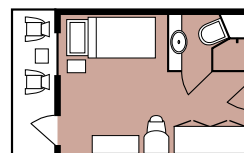

Note: Stateroom information provided is a general representation of the stateroom categories. Actual room configurations, features and amenities may vary slightly among and within stateroom categories.

the RIVERS ARE CALLING



Pre-cruise hotel stay



Open bars and lounges throughout the boat



Hop-On Hop-Off shore excursions



Internet service



Room service 24 hours a day

 **AMERICAN QUEEN®
STEAMBOAT COMPANY**

Uniquely American River Cruises