



2022 CRUISE GUIDE AMERICAN QUEEN®



AMERICAN QUEEN®
STEAMBOAT COMPANY

Uniquely American River Cruises



AMERICAN QUEEN VOYAGE CALENDAR

ALL VOYAGES ARE 9 DAYS UNLESS NOTED OTHERWISE.

DATE	ITINERARY	PORTS
Feb 20	New Orleans to Memphis	<i>Nottoway, St. Francisville, Natchez, Vicksburg, Port of the Mississippi Delta</i>
Feb 27	Memphis to New Orleans	<i>Port of the Mississippi Delta, Vicksburg, Natchez, St. Francisville, Baton Rouge, Nottoway</i>
Mar 6	New Orleans to Memphis	<i>Nottoway, St. Francisville, Natchez, Vicksburg, Port of the Mississippi Delta</i>
Mar 13	Memphis to New Orleans	<i>Port of the Mississippi Delta, Vicksburg, Natchez, St. Francisville, Baton Rouge, Nottoway</i>
Mar 20	New Orleans to Memphis	<i>Nottoway, St. Francisville, Natchez, Vicksburg, Port of the Mississippi Delta</i>
Mar 27	Memphis to New Orleans	<i>Port of the Mississippi Delta, Vicksburg, Natchez, St. Francisville, Baton Rouge, Nottoway</i>
Apr 3	New Orleans to Memphis	<i>Nottoway, St. Francisville, Natchez, Vicksburg, Port of the Mississippi Delta</i>
Apr 10	Memphis to New Orleans	<i>Port of the Mississippi Delta, Vicksburg, Natchez, St. Francisville, Baton Rouge, Nottoway</i>
Apr 17	New Orleans to Memphis	<i>Nottoway, St. Francisville, Natchez, Vicksburg, Port of the Mississippi Delta</i>
Apr 24	Memphis to New Orleans	<i>Port of the Mississippi Delta, Vicksburg, Natchez, St. Francisville, Baton Rouge, Nottoway</i>
May 1	New Orleans to Memphis	<i>Nottoway, St. Francisville, Natchez, Vicksburg, Port of the Mississippi Delta</i>
May 8	Memphis to New Orleans	<i>Port of the Mississippi Delta, Vicksburg, Natchez, St. Francisville, Baton Rouge, Nottoway</i>
May 15	New Orleans to Memphis	<i>Nottoway, St. Francisville, Natchez, Vicksburg, Port of the Mississippi Delta</i>
May 22	Memphis to New Orleans	<i>Port of the Mississippi Delta, Vicksburg, Natchez, St. Francisville, Baton Rouge, Nottoway</i>
May 29	New Orleans to Memphis	<i>Nottoway, St. Francisville, Natchez, Vicksburg, Port of the Mississippi Delta</i>
Jun 5	Memphis to Nashville (Clarksville)	<i>New Madrid, Cape Girardeau, Paducah, Dover, Clarksville</i>
Jun 12	Nashville (Clarksville) to Louisville	<i>Clarksville, Dover, Paducah, Henderson, Owensboro, Brandenburg</i>
Jun 19	Louisville to Nashville (Clarksville)	<i>Brandenburg, Owensboro, Henderson, Paducah, Dover, Clarksville</i>
Jun 26	Nashville (Clarksville) to Memphis	<i>Clarksville, Dover, Paducah, Cape Girardeau, Columbus, New Madrid</i>
Jul 3	Memphis to Nashville (Clarksville)	<i>New Madrid, Cape Girardeau, Paducah, Dover, Clarksville</i>
Jul 10	Nashville (Clarksville) to Memphis	<i>Clarksville, Dover, Paducah, Cape Girardeau, Columbus, New Madrid</i>
Jul 17	Memphis to St. Louis	<i>New Madrid, Paducah, Cape Girardeau, Chester, Alton</i>
Jul 24	St. Louis to Louisville	<i>Chester, Cape Girardeau, Paducah, Henderson, Owensboro, Brandenburg</i>
Jul 31	Louisville to Pittsburgh	<i>Madison, Cincinnati, Maysville, Point Pleasant, Marietta</i>
Aug 7	Pittsburgh to Louisville	<i>Wheeling, Marietta, Huntington, Augusta, Cincinnati, Madison</i>
Aug 14	Louisville to St. Louis (Alton)	<i>Brandenburg, Owensboro, Henderson, Paducah, Cape Girardeau, St. Louis</i>
Aug 21	St. Louis (Alton) to Minneapolis (Red Wing)	<i>Hannibal, Bettendorf (Quad Cities), Dubuque, La Crosse, Red Wing</i>
Aug 28	Minneapolis (Red Wing) to St. Louis (Alton)	<i>Red Wing, La Crosse, Dubuque, Bettendorf (Quad Cities), Burlington, Hannibal</i>
Sep 4	St. Louis (Alton) to Minneapolis (Red Wing)	<i>Hannibal, Bettendorf (Quad Cities), Dubuque, La Crosse, Red Wing</i>
Sep 11	Minneapolis (Red Wing) to New Orleans (16 days)	<i>Winona, La Crosse, Dubuque, Bettendorf (Quad Cities), Burlington, Hannibal, St. Louis Memphis, Port of the Mississippi Delta, Vicksburg, Natchez, Nottoway</i>
Sep 25	New Orleans to Memphis	<i>Nottoway, St. Francisville, Natchez, Vicksburg, Port of the Mississippi Delta</i>
Oct 2	Memphis to St. Louis (Alton)	<i>New Madrid, Paducah, Cape Girardeau, Chester, St. Louis</i>
Oct 9	St. Louis (Alton) to Minneapolis (Red Wing)	<i>Hannibal, Bettendorf (Quad Cities), Dubuque, La Crosse, Red Wing</i>
Oct 16	Minneapolis (Red Wing) to St. Louis (Alton)	<i>Red Wing, La Crosse, Dubuque, Bettendorf (Quad Cities), Burlington, Hannibal</i>
Oct 23	St. Louis (Alton) to Nashville (Clarksville)	<i>St. Louis, Chester, Cape Girardeau, Paducah, Dover, Clarksville</i>
Oct 30	Nashville (Clarksville) to Chattanooga	<i>Dover, Paducah, Savannah, Florence, Decatur</i>
Nov 6	Chattanooga to Nashville (Clarksville)	<i>Chattanooga, Decatur, Florence, Savannah, Paducah, Dover</i>
Nov 13	Nashville (Clarksville) to Memphis	<i>Clarksville, Dover, Paducah, Cape Girardeau, Columbus, New Madrid</i>
Nov 20	Memphis to New Orleans	<i>Port of the Mississippi Delta, Vicksburg, Natchez, St. Francisville, Baton Rouge, Nottoway</i>
Nov 27	New Orleans to Memphis	<i>Nottoway, St. Francisville, Natchez, Vicksburg, Port of the Mississippi Delta</i>
Dec 4	Memphis to New Orleans	<i>Port of the Mississippi Delta, Vicksburg, Natchez, St. Francisville, Baton Rouge, Nottoway</i>
Dec 11	New Orleans to Memphis	<i>Nottoway, St. Francisville, Natchez, Vicksburg, Port of the Mississippi Delta</i>
Dec 18	Memphis to New Orleans	<i>Port of the Mississippi Delta, Vicksburg, Natchez, St. Francisville, Nottoway</i>
Dec 25	Roundtrip New Orleans	<i>St. Francisville, Natchez, Vicksburg, Baton Rouge, Nottoway</i>

	VOYAGE NAME	E	D	C	B	A	PS	JS	DS	LS	OS	SI	SD
👑	Exploring Haunted History	\$2,199	\$3,599	\$3,799	\$4,099	\$4,199	\$4,299	\$4,299	\$4,799	\$6,799	\$8,099	\$2,699	\$3,299
👑	Exploring Haunted History	\$2,399	\$3,999	\$4,199	\$4,599	\$4,699	\$4,799	\$4,799	\$5,399	\$7,599	\$9,099	\$3,099	\$3,699
👑	Exploring Haunted History	\$2,399	\$3,999	\$4,199	\$4,599	\$4,699	\$4,799	\$4,799	\$5,399	\$7,599	\$9,099	\$3,099	\$3,699
	Lower Mississippi	\$2,399	\$3,999	\$4,199	\$4,599	\$4,699	\$4,799	\$4,799	\$5,399	\$7,599	\$9,099	\$3,099	\$3,699
	Lower Mississippi	\$2,399	\$3,999	\$4,199	\$4,599	\$4,699	\$4,799	\$4,799	\$5,399	\$7,599	\$9,099	\$3,099	\$3,699
	Lower Mississippi	\$2,399	\$3,999	\$4,199	\$4,599	\$4,699	\$4,799	\$4,799	\$5,399	\$7,599	\$9,099	\$3,099	\$3,699
	Lower Mississippi	\$2,699	\$4,499	\$4,799	\$5,099	\$5,299	\$5,399	\$5,399	\$5,999	\$8,499	\$10,199	\$3,399	\$4,099
	Lower Mississippi	\$2,299	\$3,799	\$4,099	\$4,299	\$4,499	\$4,599	\$4,599	\$5,099	\$7,299	\$8,599	\$2,299	\$2,799
	Lower Mississippi	\$2,699	\$4,499	\$4,799	\$5,099	\$5,299	\$5,399	\$5,399	\$5,999	\$8,499	\$10,199	\$3,399	\$4,099
	Lower Mississippi	\$2,699	\$4,499	\$4,799	\$5,099	\$5,299	\$5,399	\$5,399	\$5,999	\$8,499	\$10,199	\$3,399	\$4,099
	Lower Mississippi	\$2,699	\$4,499	\$4,799	\$5,099	\$5,299	\$5,399	\$5,399	\$5,999	\$8,499	\$10,199	\$3,399	\$4,099
	Lower Mississippi	\$2,699	\$4,499	\$4,799	\$5,099	\$5,299	\$5,399	\$5,399	\$5,999	\$8,499	\$10,199	\$3,399	\$4,099
	Lower Mississippi	\$2,699	\$4,499	\$4,799	\$5,099	\$5,299	\$5,399	\$5,399	\$5,999	\$8,499	\$10,199	\$3,399	\$4,099
	Lower Mississippi	\$2,699	\$4,499	\$4,799	\$5,099	\$5,299	\$5,399	\$5,399	\$5,999	\$8,499	\$10,199	\$3,399	\$4,099
👑	Music of the 50s and 60s	\$2,699	\$4,499	\$4,799	\$5,099	\$5,299	\$5,399	\$5,399	\$5,999	\$8,499	\$10,199	\$3,399	\$4,099
👑	Celebrate the 70s	\$2,699	\$4,499	\$4,799	\$5,099	\$5,299	\$5,399	\$5,399	\$5,999	\$8,499	\$10,199	\$3,399	\$4,099
👑	Founder's Cruise	\$2,599	\$4,199	\$4,499	\$4,799	\$4,999	\$5,099	\$5,099	\$5,699	\$7,999	\$9,599	\$3,199	\$3,899
👑	Celebrate the 70s	\$2,599	\$4,199	\$4,499	\$4,799	\$4,999	\$5,099	\$5,099	\$5,699	\$7,999	\$9,599	\$3,199	\$3,899
👑	Star-Spangled Cruise	\$2,599	\$4,199	\$4,499	\$4,799	\$4,999	\$5,099	\$5,099	\$5,699	\$7,999	\$9,599	\$3,199	\$3,899
👑	Music of the 50s and 60s	\$2,599	\$4,199	\$4,499	\$4,799	\$4,999	\$5,099	\$5,099	\$5,699	\$7,999	\$9,599	\$3,199	\$3,899
👑	American Culinary Experience	\$2,599	\$4,199	\$4,499	\$4,799	\$4,999	\$5,099	\$5,099	\$5,699	\$7,999	\$9,599	\$3,199	\$3,899
👑	American Culinary Experience	\$2,599	\$4,199	\$4,499	\$4,799	\$4,999	\$5,099	\$5,099	\$5,699	\$7,999	\$9,599	\$3,199	\$3,899
	Ohio River Exploration	\$2,699	\$4,499	\$4,799	\$5,099	\$5,299	\$5,399	\$5,399	\$5,999	\$8,499	\$10,199	\$3,399	\$4,099
	Ohio River Exploration	\$2,699	\$4,499	\$4,799	\$5,099	\$5,299	\$5,399	\$5,399	\$5,999	\$8,499	\$10,199	\$3,399	\$4,099
👑	Bourbon – An American Spirit	\$2,599	\$4,199	\$4,499	\$4,799	\$4,999	\$5,099	\$5,099	\$5,699	\$7,999	\$9,599	\$3,199	\$3,899
	Upper Mississippi	\$2,699	\$4,499	\$4,799	\$5,099	\$5,299	\$5,399	\$5,399	\$5,999	\$8,499	\$10,199	\$3,399	\$4,099
	Upper Mississippi	\$2,699	\$4,499	\$4,799	\$5,099	\$5,299	\$5,399	\$5,399	\$5,999	\$8,499	\$10,199	\$3,399	\$4,099
	Upper Mississippi	\$2,699	\$4,499	\$4,799	\$5,099	\$5,299	\$5,399	\$5,399	\$5,999	\$8,499	\$10,199	\$3,399	\$4,099
	The Mighty Mississippi	\$5,099	\$8,399	\$8,899	\$9,499	\$9,899	\$10,099	\$10,099	\$11,199	\$15,899	\$18,999	\$6,399	\$7,699
	Lower Mississippi	\$2,699	\$4,499	\$4,799	\$5,099	\$5,299	\$5,399	\$5,399	\$5,999	\$8,499	\$10,199	\$3,399	\$4,099
👑	Celebrate the 70s	\$2,699	\$4,499	\$4,799	\$5,099	\$5,299	\$5,399	\$5,399	\$5,999	\$8,499	\$10,199	\$3,399	\$4,099
	Upper Mississippi	\$2,699	\$4,499	\$4,799	\$5,099	\$5,299	\$5,399	\$5,399	\$5,999	\$8,499	\$10,199	\$3,399	\$4,099
	Upper Mississippi	\$2,699	\$4,499	\$4,799	\$5,099	\$5,299	\$5,399	\$5,399	\$5,999	\$8,499	\$10,199	\$3,399	\$4,099
👑	American Culinary Experience	\$2,699	\$4,499	\$4,799	\$5,099	\$5,299	\$5,399	\$5,399	\$5,999	\$8,499	\$10,199	\$3,399	\$4,099
👑	Civil War: A Historical Perspective	\$2,699	\$4,499	\$4,799	\$5,099	\$5,299	\$5,399	\$5,399	\$5,999	\$8,499	\$10,199	\$3,399	\$4,099
👑	Civil War: A Historical Perspective	\$2,299	\$3,799	\$3,999	\$4,299	\$4,499	\$4,599	\$4,599	\$5,099	\$7,199	\$8,599	\$2,899	\$3,499
👑	American Music Festival	\$2,299	\$3,799	\$3,999	\$4,299	\$4,499	\$4,599	\$4,599	\$5,099	\$7,199	\$8,599	\$2,899	\$3,499
👑	Thanksgiving	\$1,999	\$3,199	\$3,399	\$3,699	\$3,799	\$3,899	\$3,899	\$4,299	\$6,099	\$7,299	\$2,499	\$2,999
👑	Exploring Haunted History	\$2,199	\$3,599	\$3,799	\$4,099	\$4,199	\$4,299	\$4,299	\$4,799	\$6,799	\$8,099	\$2,699	\$3,299
👑	Mississippi Holiday Markets	\$2,199	\$3,599	\$3,799	\$4,099	\$4,199	\$4,299	\$4,299	\$4,799	\$6,799	\$8,099	\$2,699	\$3,299
👑	Mississippi Holiday Markets	\$2,199	\$3,599	\$3,799	\$4,099	\$4,199	\$4,299	\$4,299	\$4,799	\$6,799	\$8,099	\$2,699	\$3,299
👑	Cajun Christmas	\$2,199	\$3,599	\$3,799	\$4,099	\$4,199	\$4,299	\$4,299	\$4,799	\$6,799	\$8,099	\$2,699	\$3,299
👑	New Year's Celebration	\$2,199	\$3,599	\$3,799	\$4,099	\$4,199	\$4,299	\$4,299	\$4,799	\$6,799	\$8,099	\$2,699	\$3,299



Denotes a special edition voyage

Fares quoted are in U.S. dollars, per person, double occupancy, with the exception of single-occupancy categories SI and SO. Fares do not include taxes, port charges, insurance, gratuities, airfare or land transportation. All itineraries, hotels, pricing, dates and voyage names are subject to change, and we are not responsible for errors or omissions therein.

DECK PLANS

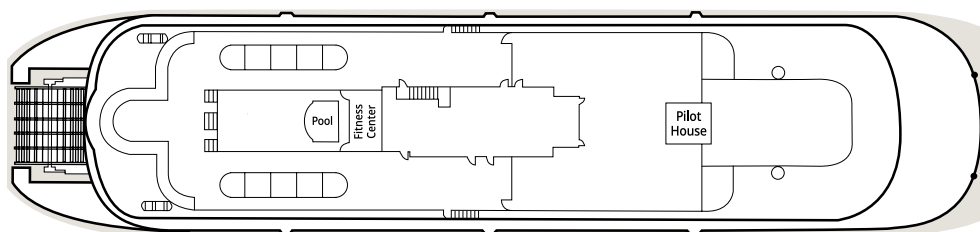

DECK 6 – SUN DECK

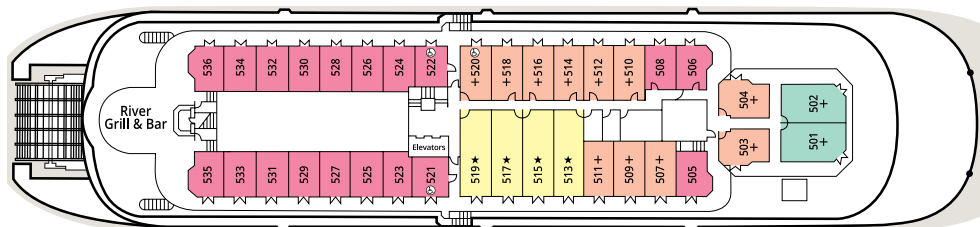

DECK 5 – PROMENADE DECK

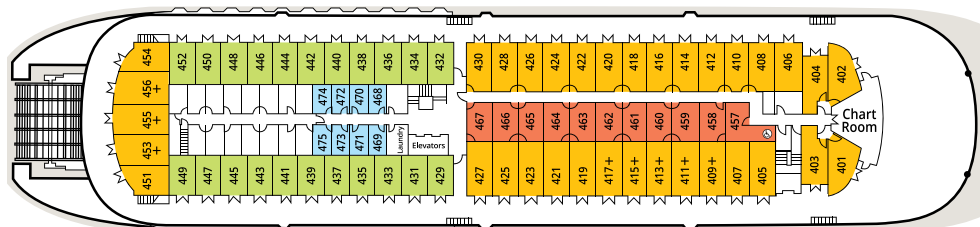

DECK 4 – OBSERVATION DECK

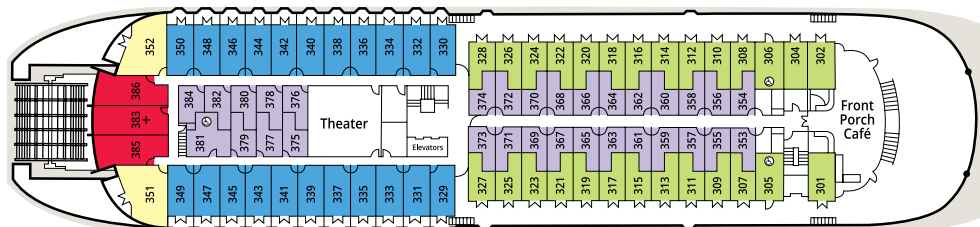

DECK 3 – TEXAS DECK

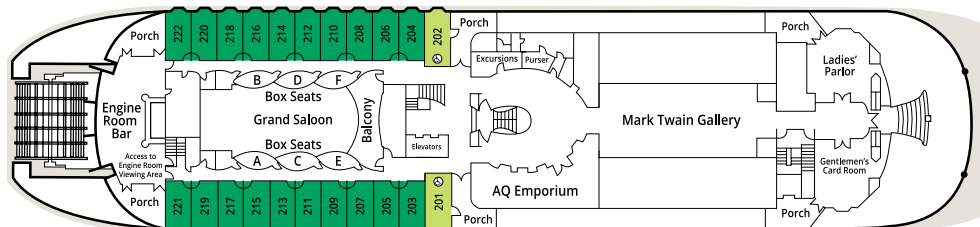

DECK 2 – CABIN DECK

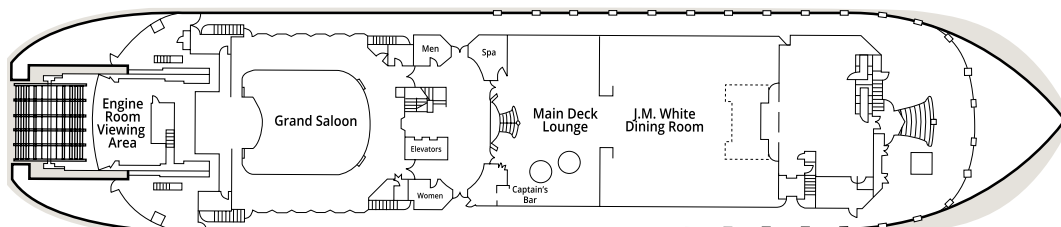

DECK 1 – MAIN DECK

SUITE AND STATEROOM CATEGORIES

- OS** Owner's Suites with Exclusive Veranda
- LS** Luxury Suites with Private or Open Veranda
- DS** Deluxe Suites with Open Veranda
- JS** Junior Suites with Open Veranda
- PS** Paddlewheel Staterooms
- A** Deluxe Outside Staterooms with Private Veranda
- B** Outside Staterooms with Open Veranda
- C** Outside Staterooms with Open Veranda
- D** Deluxe Outside Staterooms with Bay Window
- E** Inside Staterooms
- SD** Single Deluxe Staterooms
- SI** Single Inside Staterooms

- +** Triple Occupancy
- ★** Quadruple Occupancy
- ♿** Accessible/Partially Accessible Suites and Staterooms

Stateroom 381 features a roll-in shower.

Featuring separate entrances with interior connecting doors, category E staterooms 458 to 467 connect with the adjoining odd-numbered B outside staterooms 409 to 427.

SPECIFICATIONS

YEAR BUILT 1995
 REFURBISHED 2017
 LENGTH 418 FEET
 PASSENGER DECKS 6
 SUITES AND STATEROOMS 218
 PASSENGERS 417
 CREW 172

SUITES AND STATEROOMS

OS OWNER'S SUITES WITH EXCLUSIVE VERANDA

Open French doors and step out onto your veranda to unwind on your amply furnished patio. Adorned with 11-foot vaulted ceilings, overhead lighting and a cozy interior lounging area with a sofa-bed and cocktail tables, these expansive suites can accommodate up to three guests, and epitomize luxurious river cruising. Relish the many exclusive benefits of our *Commodore Services* while your personal River Butler attends to your every need.

- 348 sq. ft. with 690-sq.-ft. exclusive veranda
- Queen bed
- Full bathroom with standard tub/shower combination
- Lounging area with sofa-bed
- Dressing area with granite vanity and mirror
- Flat-screen TV
- Coffee maker and mini refrigerator
- French doors open to exclusive veranda
- Furnished patio with sofa, two chairs and a coffee table
- Interior and exterior access
- Promenade Deck
- *Commodore Services*, including a River Butler

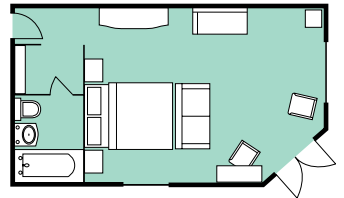

LS LUXURY SUITES WITH PRIVATE OR OPEN VERANDA

Our spacious, elegant suites are furnished to provide the warm ambiance of a fine Southern estate. Open your French doors and delight in sweeping river views as you sip a beverage and share conversation in your cozy sitting area. With two configurations to choose from – either one large room with a private veranda or two adjoining rooms with an open veranda – these suites are the ideal choice for family and friends vacationing together.

- 353-363 sq. ft. with private or open veranda
- Queen bed or two single beds
- Full bathroom with tub and shower or standard tub/shower combination
- Sitting area with sofa-bed
- Vanity, mirror and desk
- Flat-screen TV
- Coffee maker and mini refrigerator
- French doors open to deck or veranda
- Interior and exterior access
- Promenade and Texas Decks
- *Commodore Services*, including a River Butler

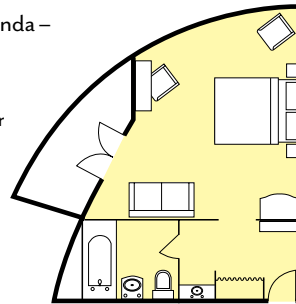

LS Suites on Texas Deck

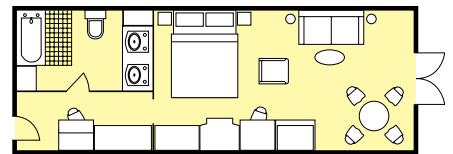

LS Suites on Promenade Deck

DS DELUXE SUITES WITH OPEN VERANDA

You will feel right at home on the river in our magnificent suites. Indulge in a soothing soak in your tub, then retire to your cozy armchair or sofa, prop your feet up on the ottoman and read through the *River Times* – our daily program – to discover the delights that await.

- 230 sq. ft. with open veranda
- Queen bed or two single beds
- Full bathroom with standard tub/shower combination
- Sitting area with sofa-bed
- Vanity and mirror
- Flat-screen TV
- French doors open to deck
- Interior and/or exterior access
- Promenade Deck
- *Commodore Services* (excludes River Butler)
- *Partially accessible suite 520 is 252 sq. ft. and features a standard tub/shower combination.*

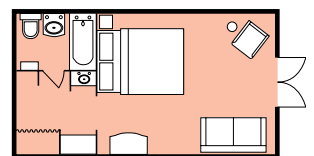

Guests holding reservations for select suite-level accommodations will receive exclusive benefits and services, including pre-boarding privileges, a bottle of wine and seasonal fruit upon arrival, preferred dining arrangements, reserved seating in the Grand Saloon, River Butler service and more. River Butler service is limited to suite categories OS and LS.

JS JUNIOR SUITES WITH OPEN VERANDA

Settle into your sitting area, open the French doors to the deck, and greet the day as the banks of the river majestically slip by. Some staterooms in this category offer a view of the paddlewheel, while others provide expansive views of America's heartland.

- 210 sq. ft. with open veranda
- Queen bed or two single beds
- Full bathroom with standard tub/shower combination
- Flat-screen TV
- Sitting area
- Vanity and mirror
- French doors open to deck
- Interior and/or exterior access
- Promenade and Observation Decks
- Preferred dining arrangements
- *Partially accessible suites 521 and 522 are 210 sq. ft. and feature a standard tub/shower combination.*

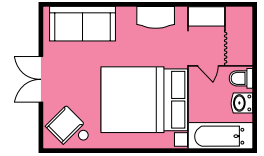

PS PADDLEWHEEL STATEROOMS

These spacious retreats offer unmatched views, each with a 6-foot-square viewing window that overlooks the paddlewheel, for a truly authentic steamboating experience. Guests are enamored with the allure of the more traditional experience from sound and vibration of the close proximity of the turning paddlewheel.

- Stateroom 383: 342 sq. ft.
- Staterooms 385 and 386: 302 sq. ft.
- Traditional paddlewheel experience
- Queen bed or two single beds
- Full bathroom with standard tub/shower combination
- Flat-screen TV
- Sitting area with sofa-bed
- 6-foot-square picture window overlooking the paddlewheel
- Vanity, mirror and desk
- Interior access
- Texas Deck

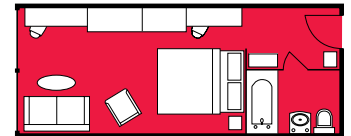

A DELUXE OUTSIDE STATEROOMS WITH PRIVATE VERANDA

With a private veranda, these staterooms are so enjoyable that you might decide to extend your journey. Relax in a cozy armchair and enjoy the view as you anticipate the activities of the day.

- 190 sq. ft. with 40-sq.-ft. private veranda
- Queen bed or two single beds
- Full bathroom with standard tub/shower combination
- Flat-screen TV
- French doors open to private veranda
- Interior access
- Texas Deck

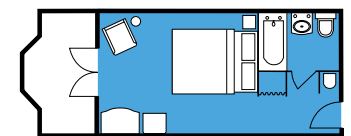

B OUTSIDE STATEROOMS WITH OPEN VERANDA

Can you imagine opening French doors to a sweeping river vista and the sweet scent of magnolia trees? Sit on the deck outside your stateroom and greet early-morning strollers, relax in bed with your favorite book or soak in a hot bath.

- 190-205 sq. ft. with open veranda
- Queen bed or two single beds
- Full bathroom with standard tub/shower combination
- Flat-screen TV
- French doors open to deck
- Interior and/or exterior access
- Observation Deck

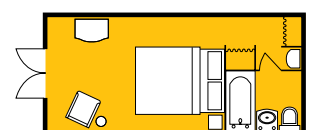

C OUTSIDE STATEROOMS WITH OPEN VERANDA

Open your French doors, and enjoy the fresh air. Sit on the deck outside your stateroom, and take in the gently changing views of the landscape, or indulge in a leisurely morning in bed with room service.

- 140-160 sq. ft. with open veranda
- Queen bed or two single beds
- Full bathroom with shower or standard tub/shower combination
- Flat-screen TV
- French doors open to deck
- Exterior access
- Observation, Texas and Cabin Decks
- *Partially accessible staterooms 201 and 202 (210 sq. ft.) and 305 and 306 (180 sq. ft.) feature standard tub/shower combinations.*

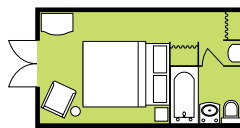

D DELUXE OUTSIDE STATEROOMS WITH BAY WINDOW

An expansive bay window overlooking the scenery of America's heartland is the main draw of this spacious category. Curl up in front of the window with a new novel, and savor a moment that belongs to only you.

- 190 sq. ft. with bay window
- Queen bed or two single beds
- Full bathroom with standard tub/shower combination
- Flat-screen TV
- Interior access
- Cabin Deck

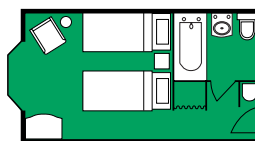

SD SINGLE DELUXE STATEROOMS

Greet the day in your cozy stateroom, relaxing before breakfast, or simply enjoy a leisurely morning in bed with room service.

- 140 sq. ft.
- Queen bed
- Full bathroom with shower
- Flat-screen TV
- Interior access
- Observation Deck
- *Partially accessible stateroom 457 is 167 sq. ft. and features a standard tub/shower combination.*

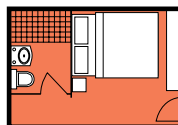

E INSIDE STATEROOMS

Surrounded by wonderful period details, accompanied by every modern convenience, these cozy havens will make your cares disappear. Ample shelving and storage spaces keep necessities out of the way yet easily accessible.

- 132 sq. ft.
- Queen bed or two single beds
- Full bathroom with shower
- Flat-screen TV
- Interior access
- Texas Deck
- *Accessible stateroom 381 is 217 sq. ft. and features a roll-in shower.*

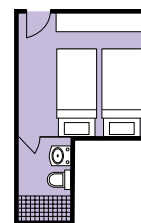

SI SINGLE INSIDE STATEROOMS

These intimate cabins with ample storage space are slightly scaled down to accommodate the independent traveler, and feature a single bed.

- 80 sq. ft.
- Single bed
- Full bathroom with shower
- Flat-screen TV
- Interior access
- Observation Deck

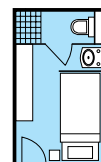

Note: Stateroom information provided is a general representation of the stateroom categories. Actual room configurations, features and amenities may vary slightly among and within stateroom categories.

the RIVERS ARE CALLING



Pre-cruise hotel stay



Open bars and lounges
throughout the boat



Hop-On Hop-Off
shore excursions



Internet service



Room service
24 hours a day

 **AMERICAN QUEEN®
STEAMBOAT COMPANY**

Uniquely American River Cruises